

WPC Wall Cladding Installation Instruction



Toos and Accessories



Chainsaw



Tape measure



Drill



Level



Gas nailer



Joist



SS screw



Starting clip



Dovetail nails



L-corner

Easy Installation

Fixed joist

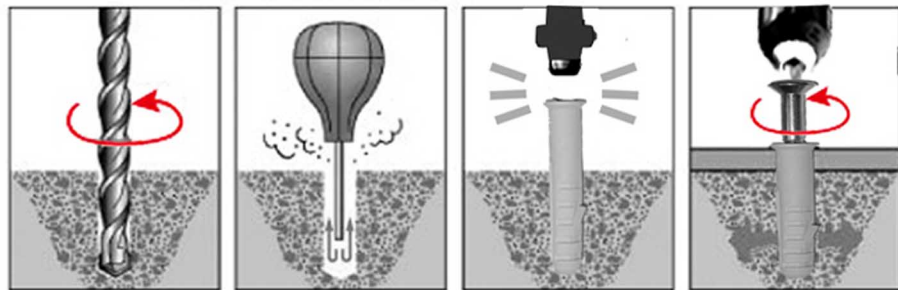

Expansion screws

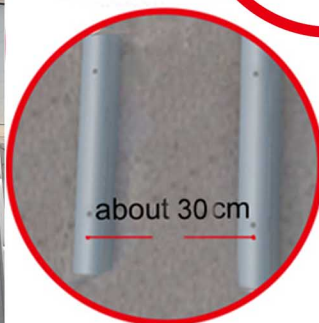

·Fixed the joist with expansion screws.

·Every **0.5 meters** an expansion screw.

WPC Wall Cladding Installation Instruction

Fixd Starting clip

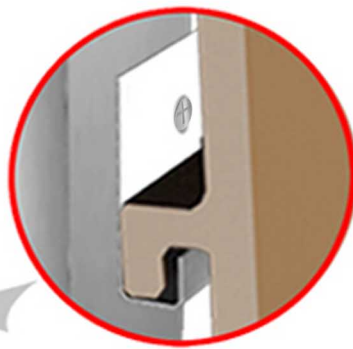
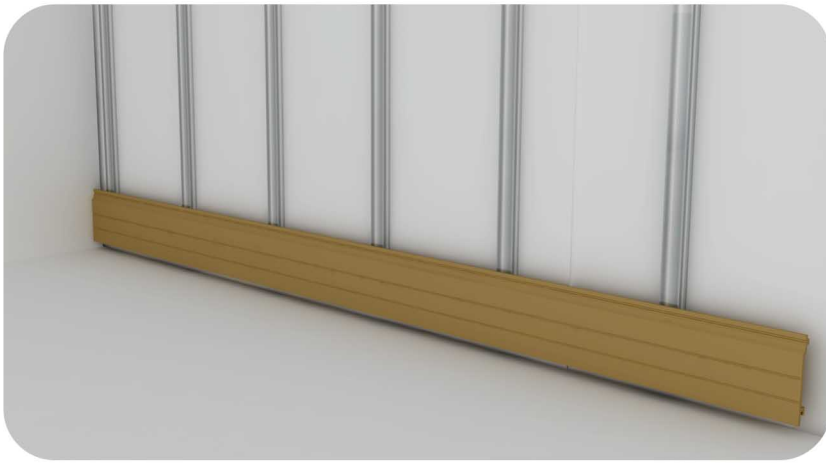
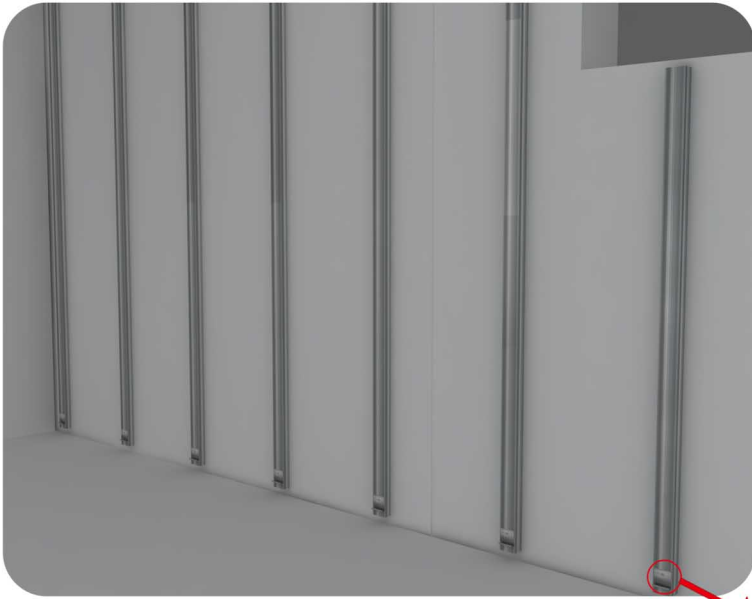

Fixed the first panel at the bottom.

Fixd wall cladding

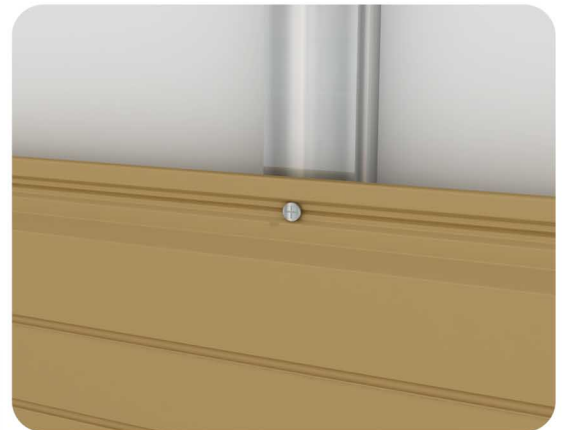
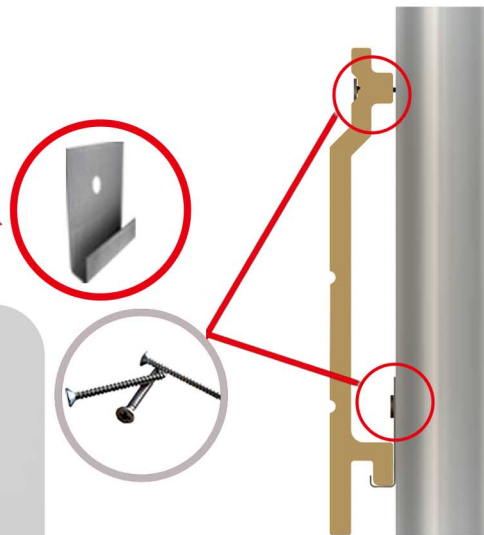

WPC Wall Cladding Installation Instruction

Fixd wall cladding

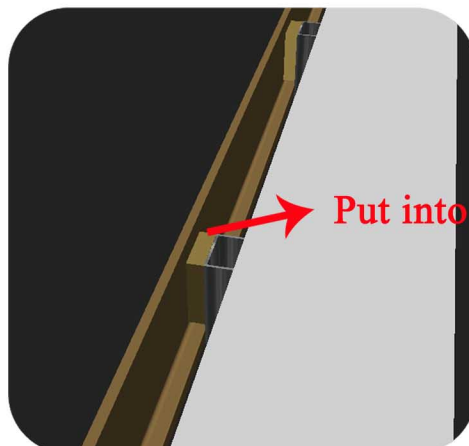
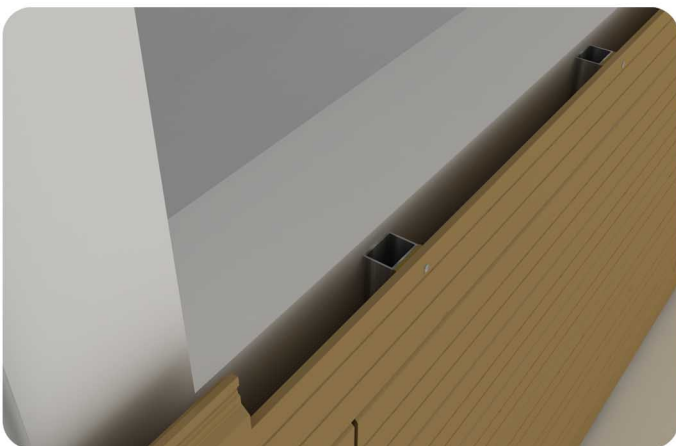
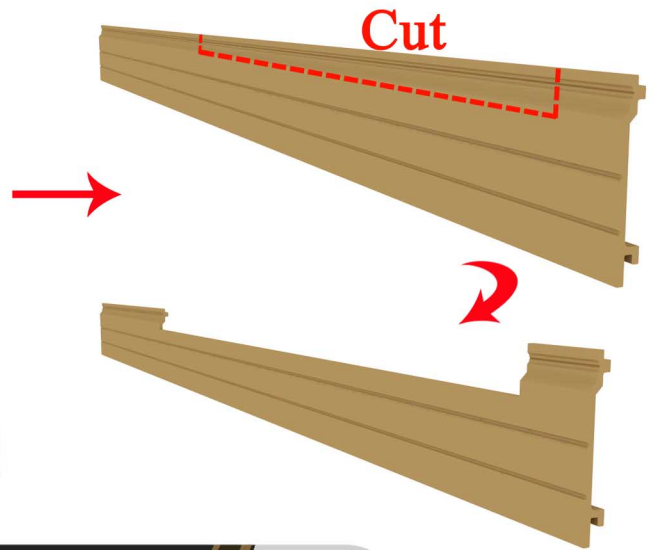
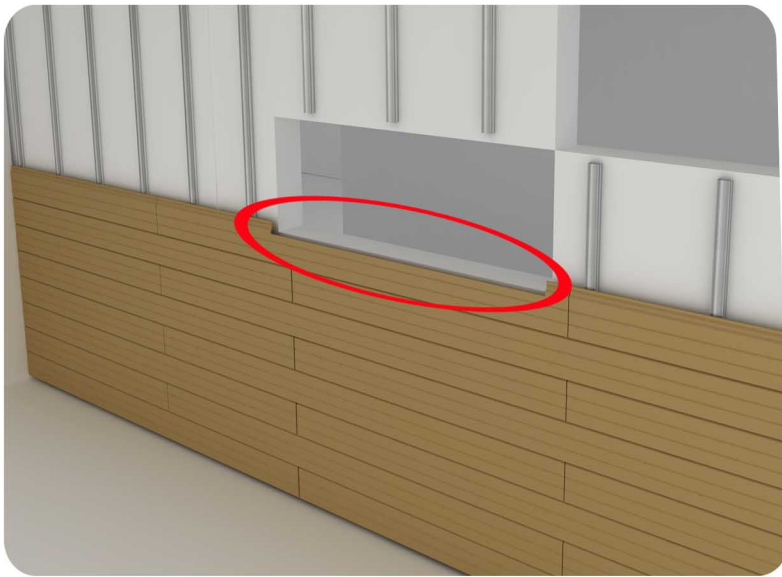
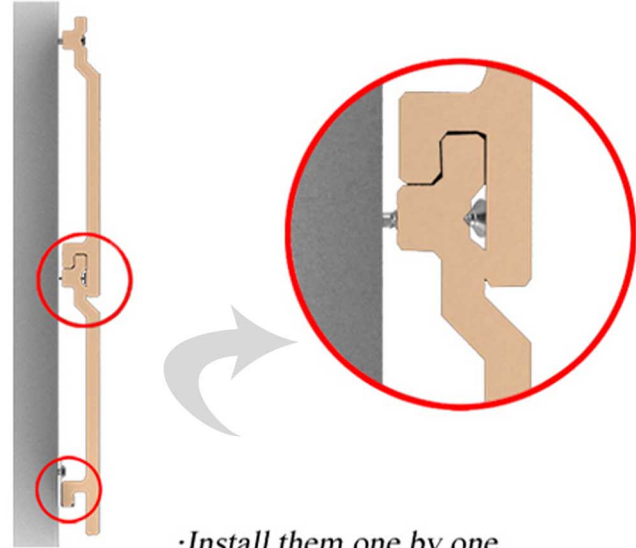
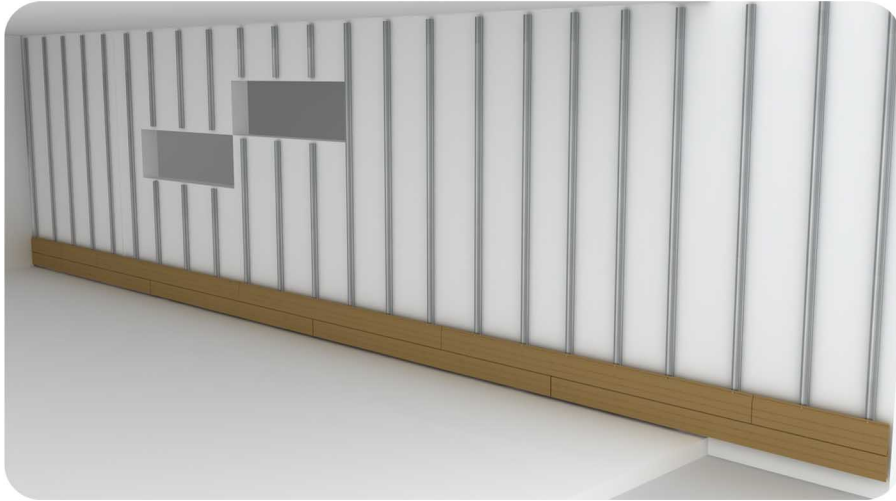

Composite Cladding
3 COOWIN GROUP

WPC Wall Cladding Installation Instruction

Fixd wall cladding

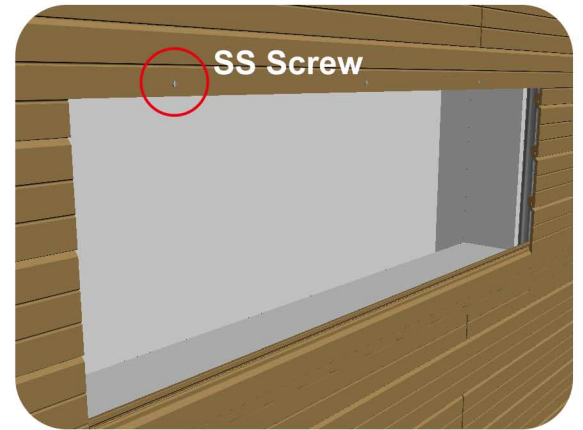

Install L Corner

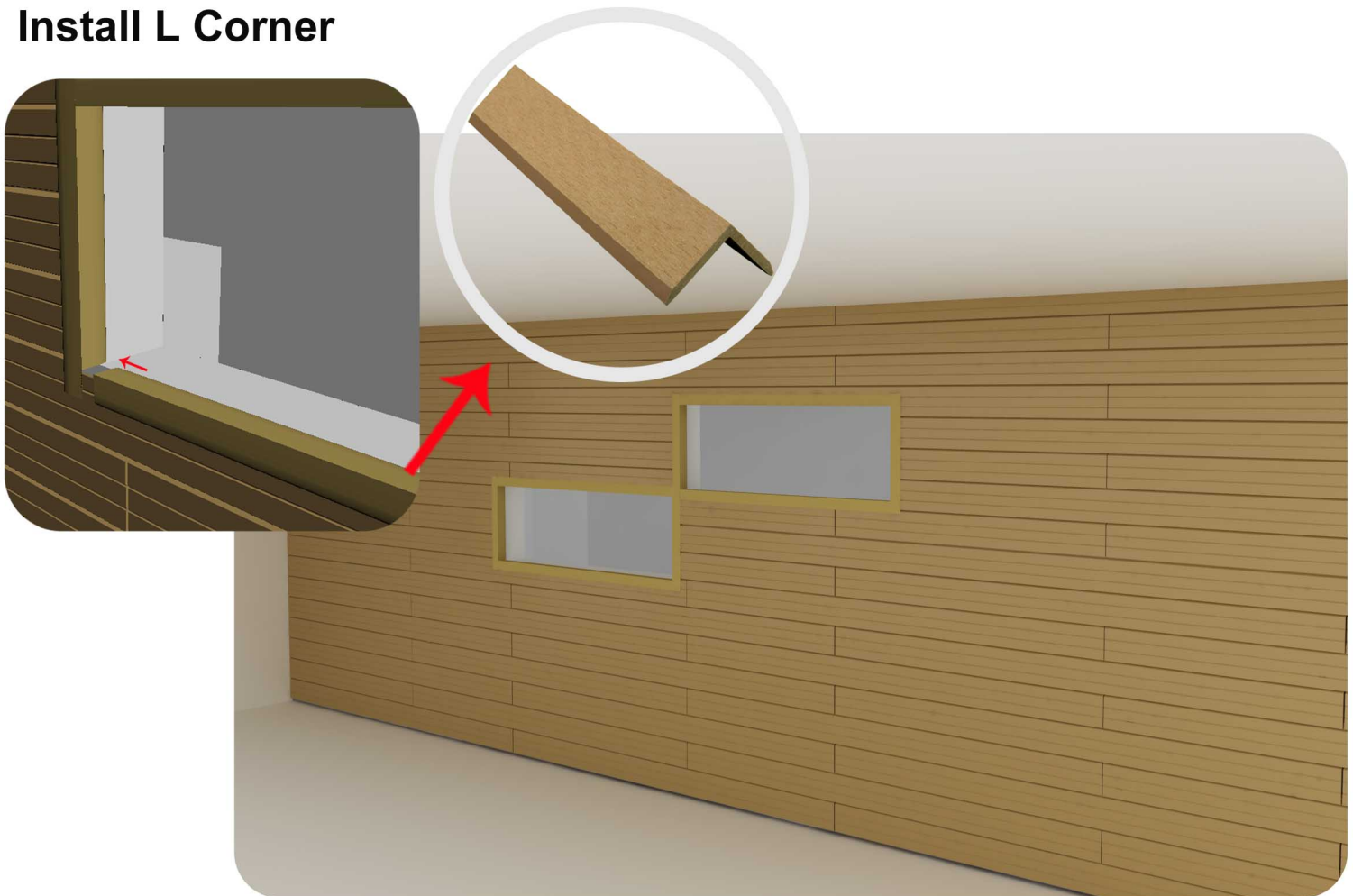

WPC Wall Cladding Installation Instruction

Install L-Corner

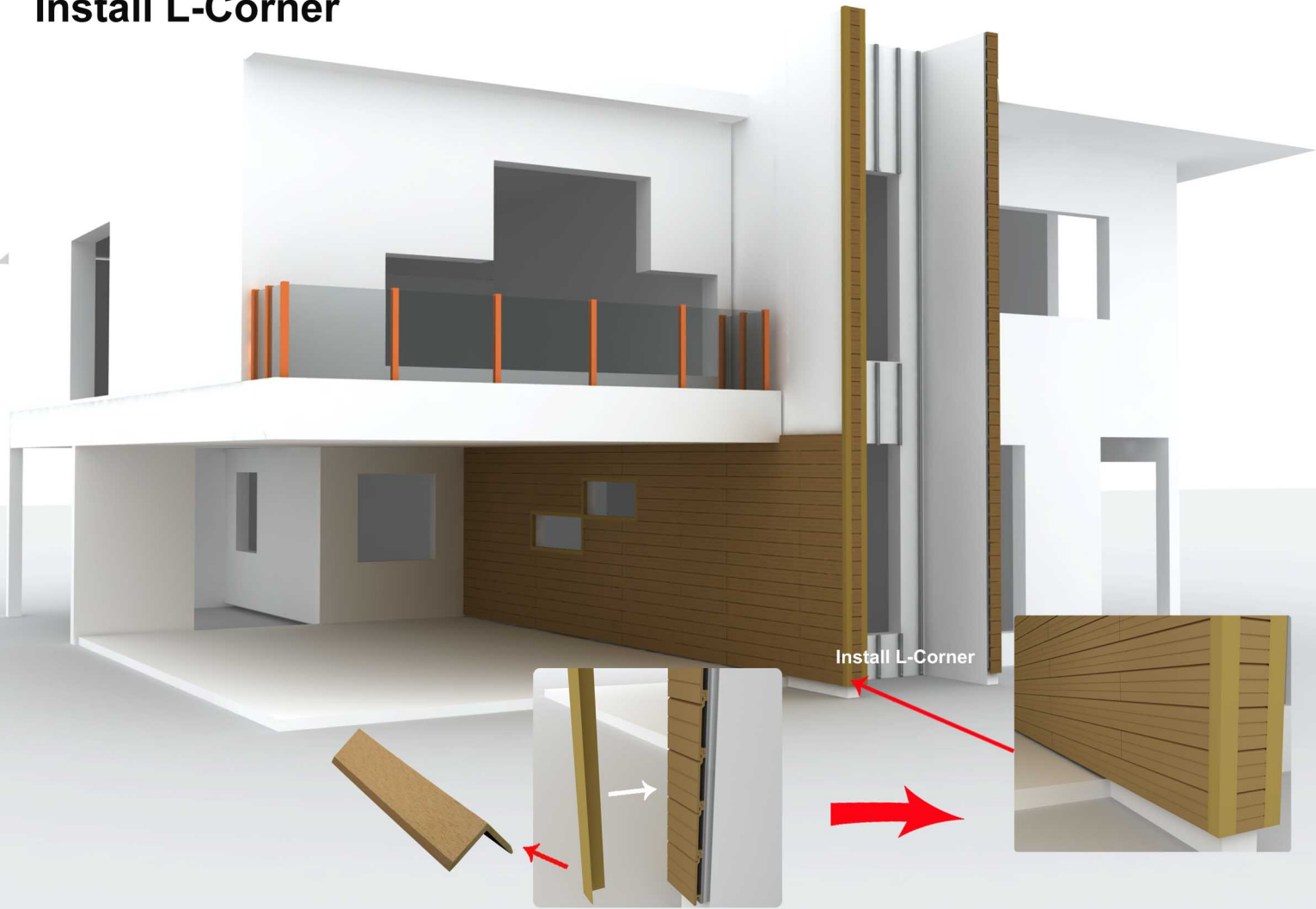

This is an example for one side of wall's installation, other walls are same with it.



Composite Cladding
COOWIN GROUP